

Apr 14, 2021 - 2:49pm Plotted By: travis.gerber V:\025800-Panda Express - Master 2018\025800.18-Hamilton\_OH\04-DWG\Eng\Sheet\025800.18-SUTS-DEMO.dwg Layout: Demo Plan

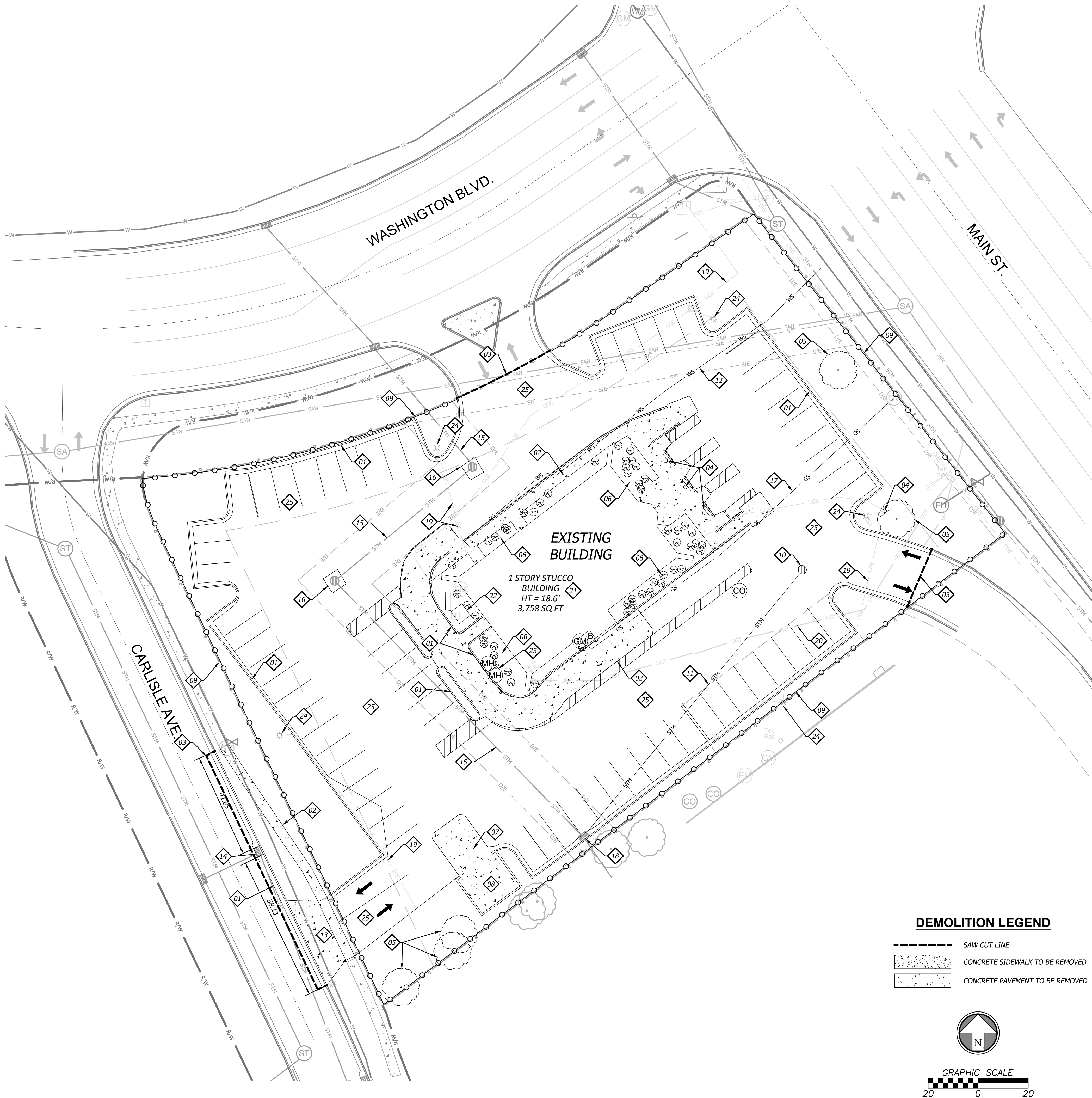

GENERAL NOTES

1. ALL MATERIALS SHALL BE REMOVED AND DISPOSED OF OFF-SITE. IT IS THE CONTRACTORS RESPONSIBILITY TO MEET ALL APPLICABLE LAWS AND REGULATIONS PERTAINING TO THE DISPOSAL OF CONSTRUCTION/DEMOLITION MATERIAL.
2. CONTRACTOR SHALL VERIFY LOCATION OF ALL UTILITIES PRIOR TO ANY EXCAVATION OR CONSTRUCTION ACTIVITY.
3. RECYCLE AS MUCH WASTE MATERIAL AS POSSIBLE. DOCUMENT RECYCLED MATERIAL.
4. ALL SAWCUTS SHALL BE DONE WITH NEAT AND CLEAN EDGES. ALL SAW CUTS SHALL BE MADE AT THE NEAREST CONSTRUCTION JOINT JOINT TO THE DIMENSION SHOWN. DIMENSION SHOWN SHALL BE MINIMUM LIMITS OF REMOVAL.
5. THE CONTRACTOR SHALL REMOVE ANY AND ALL EXISTING DEBRIS WHICH IS ENCOUNTERED FROM THE EXISTING SITE. THIS SHALL INCLUDE, BUT SHALL NOT BE LIMITED TO, FOOTINGS, CONCRETE SLABS, CONDUITS, GRANULAR SUBGRADE, UTILITY SERVICES, AND/OR UNSUITABLE STRUCTURAL FILL MATERIAL AS DETERMINED BY THE OWNER'S ENGINEER. THE COST FOR THESE REMOVALS SHALL BE CONSIDERED INCIDENTAL TO THE PROJECT. SAID DEBRIS SHALL BECOME PROPERTY OF THE CONTRACTOR AND IT SHALL BE THE RESPONSIBILITY OF THE CONTRACTOR TO DISPOSE OF PROPERLY OFF-SITE.
6. THE CONTRACTOR SHALL BE RESPONSIBLE FOR OBTAINING AND PAYMENT OF ANY PERMITS FOR DEMOLITION THAT PERTAIN TO THIS PROJECT.
7. THE CONTRACTOR SHALL ENSURE THAT ANY STRUCTURES TO REMAIN WHICH ARE DAMAGED DURING DEMOLITION OPERATIONS SHALL BE REPAIRED TO MEET CURRENT CODE, AT NO ADDITIONAL COST TO THE OWNER.
8. ALL EXISTING UTILITIES REMOVED DURING CONSTRUCTION SHALL HAVE THEIR TRENCHES BACKFILLED WITH STRUCTURAL FILL AND BE COMPACTED TO THE REQUIREMENTS FOR STRUCTURAL FILL.
9. THE CONTRACTOR IS SOLELY RESPONSIBLE FOR PROVIDING ALL TEMPORARY PIPE, MANHOLES, PUMPS, ETC. TO ENSURE CONTINUOUS SERVICE FOR STORM AND SANITARY SEWERS. BY-PASS PUMPING SHALL BE CLOSELY MONITORED, BY THE CONTRACTOR, AT ALL TIMES.
10. ALL REMOVALS REQUIRED TO PROPERLY PERFORM THE WORK (WHETHER SHOWN ON THE PLANS OR NOT) SHALL BE PERFORMED BY THE CONTRACTOR AT NO ADDITIONAL COST TO THE OWNER.
11. ALL PROTECTION FENCING SHALL BE INSTALLED PRIOR TO DEMOLITION/CONSTRUCTION ACTIVITY. THE CONTRACTOR SHALL PROVIDE A 6-FOOT SECURITY FENCE AROUND THE ENTIRE JOB SITE WITH LOCKED GATED ACCESS POINTS, IF REQUIRED BY THE OWNER OR THE CITY.

DEMOLITION NOTES

- 01 REMOVE AND DISPOSE OF EXISTING CURB.
- 02 REMOVE AND DISPOSE OF CONCRETE SIDEWALK.
- 03 SAW CUT EXISTING PAVEMENT TO FULL DEPTH AND CLEAN EDGE.
- 04 REMOVE AND DISPOSE OF EXISTING SIGN, FOOTING, ELECTRICAL SERVICE AND CONDUIT.
- 05 CONTRACTOR TO COORDINATE WITH LANDSCAPE COMPANY ON REMOVAL AND RELOCATION OF EXISTING TREES.
- 06 REMOVE AND DISPOSE OF EXISTING LANDSCAPE AREA.
- 07 REMOVE AND DISPOSE OF EXISTING CONCRETE PAD.
- 08 REMOVE AND DISPOSE OF EXISTING FENCE AND TRASH ENCLOSURE.
- 09 INSTALL PROTECTION FENCING.
- 10 REMOVE AND DISPOSE OF EXISTING CATCH BASIN.
- 11 REMOVE AND DISPOSE OF EXISTING 12" CPP
- 12 REMOVE AND DISPOSE OF EXISTING WATER SERVICE LINE, METER PIT, AND CAP AT MAIN. RETURN METER TO CITY.
- 13 REMOVE AND DISPOSE OF EXISTING CONCRETE DRIVE APPROACH.
- 14 CONTRACTOR TO MODIFY EXISTING CURB INLET. SEE STORM PLAN SHEET.
- 15 LEAVE STORM PIPE IN PLACE - DO NOT REMOVE.
- 16 SEE UTILITY PLAN FOR AREA INLET REVISIONS.
- 17 REMOVE AND DISPOSE OF EXISTING GAS SERVICE LINE AND METER BACK TO MAIN. CAP LINE AT CONNECTION POINT. COORDINATE REMOVAL WITH GAS COMPANY.
- 18 LEAVE EXISTING CURB INLET IN PLACE - DO NOT REMOVE.
- 19 REMOVE AND DISPOSE OF EXISTING ELECTRICAL SERVICE LINE AND CONDUIT. COORDINATE REMOVAL WITH UTILITY COMPANY.
- 20 REMOVE AND DISPOSE OF UNDERGROUND TELEPHONE LINE AND CONDUIT. COORDINATE REMOVAL WITH UTILITY COMPANY.
- 21 REMOVE AND DISPOSE OF EXISTING BUILDING.
- 22 EXISTING TRANSFORMER TO BE REMOVED. COORDINATE REMOVAL WITH UTILITY COMPANY.
- 23 REMOVE AND DISPOSE OF EXISTING GREASE INTERCEPTOR. CONTRACTOR TO LOCATE, REMOVE AND DISPOSE OF EXISTING SANITARY SERVICE LINE(S) BACK TO MAIN AND CAP.
- 24 RELOCATE AND REUSE EXISTING LIGHT POLE AND BASE. SEE ELECTRICAL PLANS FOR NEW LOCATIONS.
- 25 REMOVE AND DISPOSE OF EXISTING ASPHALT PAVEMENT.

DEMOLITION LEGEND

- SAW CUT LINE
- CONCRETE SIDEWALK TO BE REMOVED
- CONCRETE PAVEMENT TO BE REMOVED

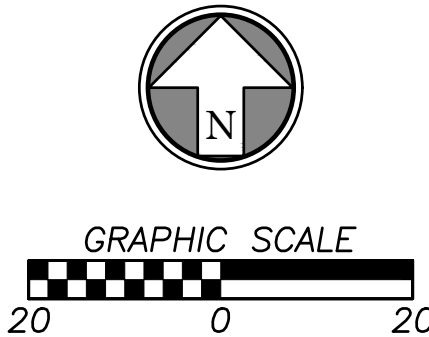

PANDA EXPRESS, INC.  
1683 Walnut Grove Ave.  
Rosemead, California  
91770  
Telephone: 626.799.9898  
Facsimile: 626.372.8288

All ideas, designs, arrangement and plans indicated or represented by this drawing are the property of Panda Express Inc. and were created for use on this specific project. None of these ideas, designs, arrangements or plans may be used by or disclosed to any person, firm, or corporation without the written permission of Panda Express Inc.

REVISIONS:

|  |  |
|--|--|
|  |  |
|  |  |
|  |  |
|  |  |
|  |  |
|  |  |
|  |  |
|  |  |
|  |  |
|  |  |

ISSUE DATE:

|     |                  |          |
|-----|------------------|----------|
| 1ST | SITE PLAN REVIEW | 02-16-21 |
| 2ND | PERMIT/BID SET   | 04-09-21 |

DRAWN BY:

PANDA PROJECT #: S8-22-D8193  
PANDA STORE #: -  
ARCH PROJECT #: 20044.021



hckloverarchitect  
8813 PENROSE LANE, SUITE 400  
LENEXA, KS 66219  
ph: 913.649.8181 • fx: 913.649.1275

PANDA EXPRESS  
TRUE WARM & WELCOME  
1485 MAIN ST.  
HAMILTON, OH 45013

DEMOLITION PLAN

C0.3

TRUE WARM & WELCOME 2300 R5

**BHC RHODES**  
Civil Engineering • Surveying • Utilities  
7101 College Blvd., Suite 400  
Overland Park, Kansas 66210  
p. (913) 663-1900 f. (913) 663-1633  
BHC RHODES is a trademark of Brungardt Honanich & Company, P.A.