

RECORD of SURVEY BOUNDARY LINE ADJUSTMENT

NOTES and LEGEND

- DENOTES 3/4" REBAR WITH PLASTIC CAP STAMPED P.L.S. 3570 SET ON THIS SURVEY
- DENOTES SPIKE WITH WASHER STAMPED P.L.S. 3570 SET ON THIS SURVEY, UNLESS OTHERWISE NOTED
- DENOTES A FOUND MONUMENT AS NOTED ON PLAT
- () DENOTES RECORD DATA PER 34-M-76 OR AS NOTED ON PLAT

BASIS OF BEARINGS IS REFERRED TO A PORTION OF THE SOUTH LINE OF PARCEL D AS SHOWN ON 7-M-57, THE BEARING OF WHICH IS S 89°47'30" W.

for
JERVA W. JONES aka JERRY W. JONES, Trustee under
Revocable Trust dated December 2, 1994

20040002209

and

LISA NEVILLE-SEGURA

2014000414

BEING A PORTION OF THE NE 1/4 SECTION 19, T. 6 N., R. 12 E., M. D. M.
COUNTY OF AMADOR, STATE OF CALIFORNIA

TOMA & ASSOCIATES INC.
ENGINEERING - SURVEYING - PLANNING
41 Summit Street, Jackson, CA 95642
(209) 223-0156

SURVEYOR'S STATEMENT

THIS MAP CORRECTLY REPRESENTS A SURVEY MADE BY ME OR UNDER MY DIRECTION IN CONFORMANCE WITH THE REQUIREMENTS OF THE PROFESSIONAL LAND SURVEYORS ACT AT THE REQUEST OF JERRY JONES IN MARCH OF 2009.

C. L. Toma 4/2/2014
CIRO L. TOMA P.L.S. 3570
MY LICENSE EXPIRES 6-30-2014

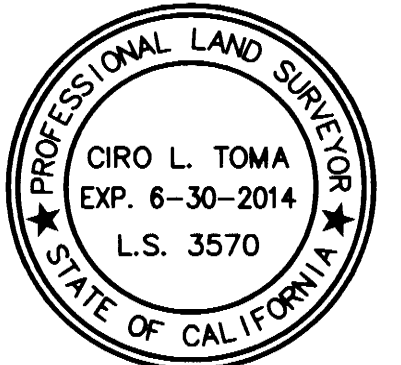

COUNTY SURVEYOR'S STATEMENT

THIS MAP HAS BEEN EXAMINED IN ACCORDANCE WITH SECTION 8766 OF THE PROFESSIONAL LAND SURVEYORS ACT THIS 9th DAY OF APRIL 2014.

George E. Allen
GEORGE E. ALLEN L.S. 4951
AMADOR COUNTY SURVEYOR
MY LICENSE EXPIRES 12-31-2015

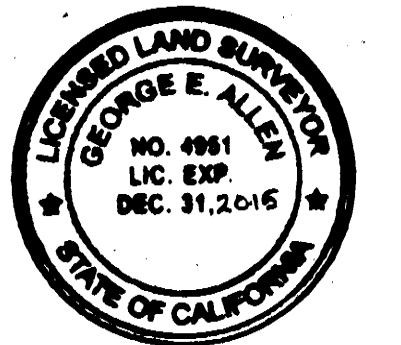

COMPLIANCE CERTIFICATE

THIS BOUNDARY LINE ADJUSTMENT IS IN COMPLIANCE WITH THE PROVISIONS OF THE SUBDIVISION MAP ACT, DIVISION 2 OF TITLE 7 OF THE GOVERNMENT CODE, AND ANY APPLICABLE ORDINANCE ENACTED PURSUANT THERETO.

THIS ADJUSTMENT MUST BE COMPLETED IN ALL ASPECTS BY THE 7th DAY OF APRIL 2015. THE EXCHANGE OF DEEDS OR COMPLIANCE CERTIFICATES MUST BE RECORDED BEFORE THE ABOVE DATE PER ORDINANCE No. 1445, CHAPTER 17.89 OF THE AMADOR COUNTY CODE.

George E. Allen
GEORGE E. ALLEN L.S. 4951
AMADOR COUNTY SURVEYOR
MY LICENSE EXPIRES 12-31-2015

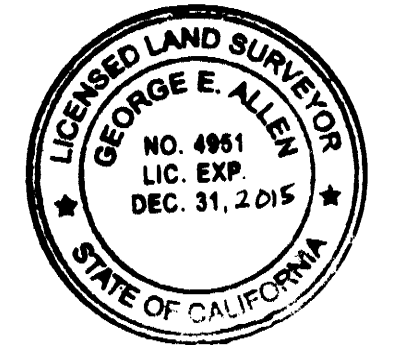

RECORDER'S STATEMENT

FILED THIS 9th DAY OF April 2014 AT 11:39 A.M.
IN BOOK 63 OF MAPS AND PLATS AT PAGE 99 AT THE REQUEST OF
THE AMADOR COUNTY SURVEYOR.

FEE: \$10.00 pd. filed

INSTRUMENT No.: 2014-0002210

Kimberly L. Grady
KIMBERLY L. GRADY
AMADOR COUNTY RECORDER

BY: _____
DEPUTY

OWNER'S STATEMENT

THE UNDERSIGNED, BEING THE OWNERS OF THE PROPERTY DELINEATED HEREON, DO HEREBY CONSENT TO THE PREPARATION AND RECORDATION OF THIS MAP.

Jerry W. Jones
JERVA W. JONES aka JERRY W. JONES
Trustee under Revocable Trust dated
December 2, 1994

Lisa Neville-Segura
LISA NEVILLE-SEGURA

