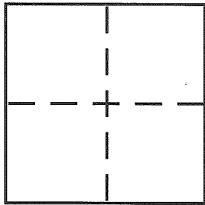

**CORNER RECORD**Document Number CR 2163  
City of BERKELEY County of ALAMEDA, CaliforniaBrief Legal Description CITY MONUMENT Cm 6511201**CORNER TYPE**

Government Corner ☐ Control ☐  
 Meander ☐ Property ☐  
 Rancho ☐ Other ☒  
 Date of Survey 4.28.04

**COORDINATES (Optional)**

N. \_\_\_\_\_  
 E. \_\_\_\_\_  
 Zone \_\_\_\_\_ NAD27 ☐ NAD83 ☐  
 NAD83 Epoch \_\_\_\_\_  
 Elev. \_\_\_\_\_  
 Vert. Datum: NGVD29 ☐ NAVD88 ☐  
 Meas. Units: Metric ☐ Imperial ☐

Corner - Left as found ☒ Found and tagged ☐ Established ☐ Reestablished ☐ Rebuilt ☐

Identification and type of corner found: Evidence used to identify or procedure used to establish or reestablish the corner:

SEE SKETCH - PAGE 2

A description of the physical condition of the monument as found and as set or reset:

SEE SKETCH - PAGE 2

**SURVEYOR'S STATEMENT**

This Corner Record was prepared by me or under my direction in conformance with the Land Surveyor's Act on 4.28.04

Signed [Signature] P.L.S or R.C.E. No. LS 5003

**COUNTY SURVEYOR'S STATEMENT**

This Corner Record was received 6.30.04

and examined and filed 8.19.04

Signed [Signature] P.L.S or R.C.E. No. 5726

Title COUNTY SURVEYOR

County Surveyor's Comment \_\_\_\_\_

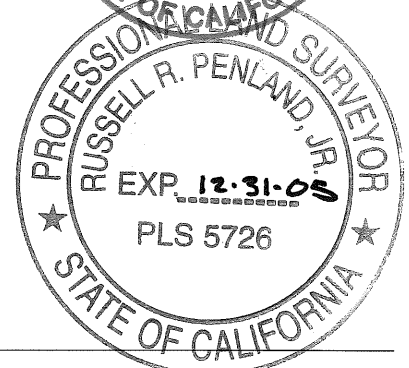
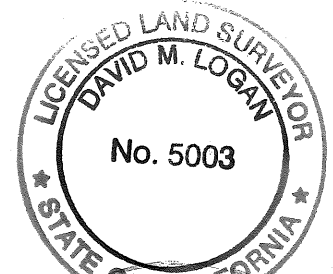

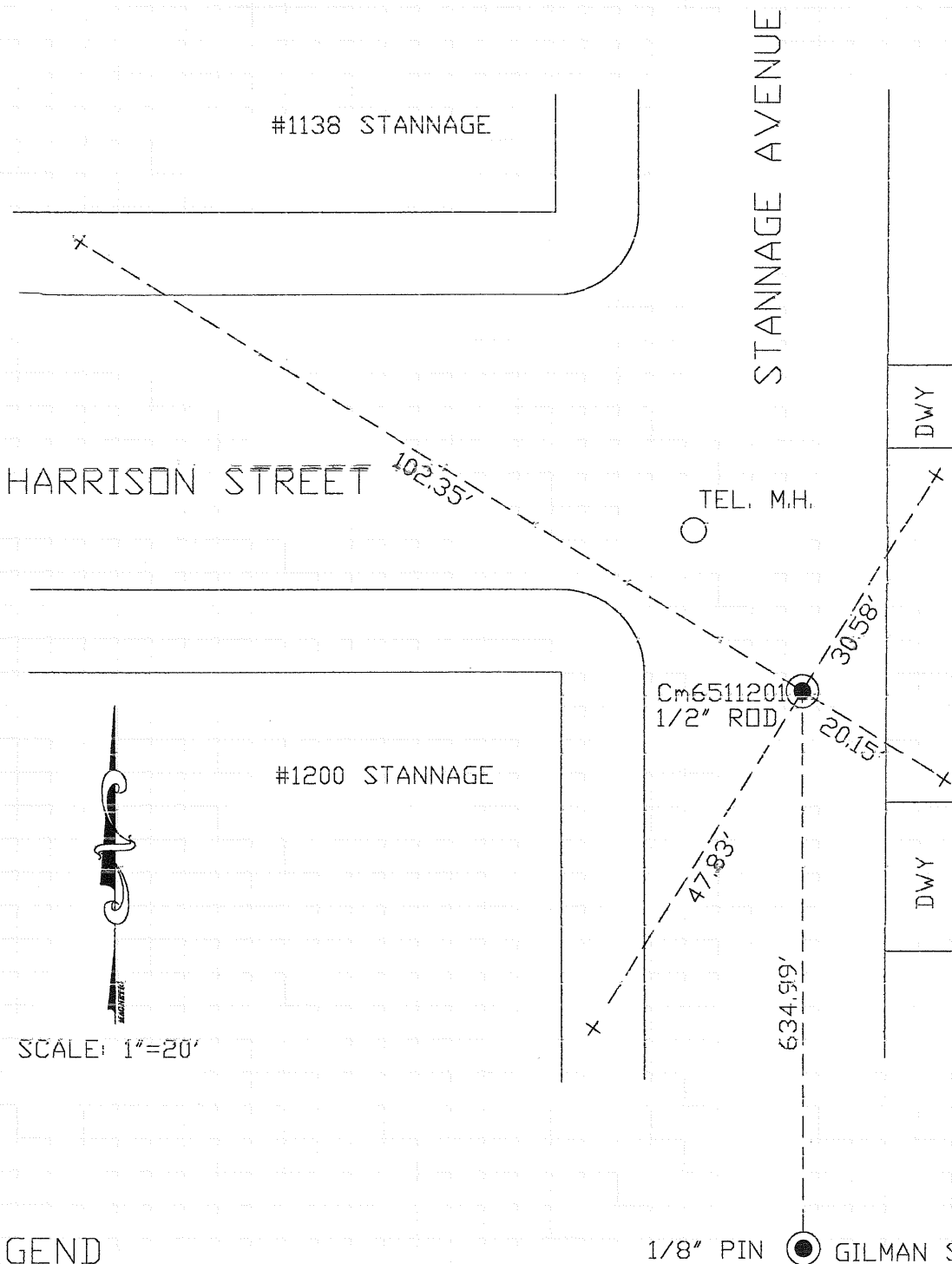

## LEGEND

- FOUND STANDARD ROUND CASTING TYPE CITY MONUMENT
- x SET CROSS ON LINE WITH MON AND OPPOSITE CROSS