

CORNER RECORD

Document Number CR 7259

City of CASTRO VALLEY

County of ALAMEDA, California

Brief Legal Description WELL MONUMENT LOCATED WITHIN HEYER AVE.

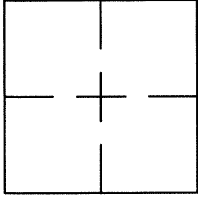

CORNER RECORD

Government Corner ☐ Control ☐
Meander ☐ Property ☒
Rancho ☐ Other ☐
Date of Survey 3/13/2015

COORDINATES
(Optional)

N. 2082521±
E. 6110600±
Zone _____ Datum _____
Elev. _____

Corner — Left as found ☒ Found and tagged ☐ Established ☐ Reestablished ☐ Rebuilt ☐

Identification and type of corner found: Evidence used to identify or procedure used to establish or reestablish the corner:
SET BRASS DISC IN MONUMENT WELL STAMPED RCE 19965 LOCATED WITHIN THE
INTERSECTION OF HEYER AVE. AND GLIDDON ST.

THIS POINT WAS FOUND IN GOOD CONDITION AFTER A CONSTRUCTION
PROJECT IN THE VICINITY

A description of the physical condition of the monument as found and as set or reset: _____
FOUND AND SET POINTS AS SHOWN ON PAGE 2.

THESE TIES ARE FOR THE PURPOSE OF PERPETUATING THE FOUND MONUMENTATION.

NO CLAIM IS MADE AS TO THE RELATIONSHIP OF THE POINTS OR LINES SHOWN HEREON
TO TRUE BOUNDARY LOCATIONS.

SURVEYOR'S STATEMENT

This Corner Record was prepared by me or under my direction in conformance with
the Land Surveyors' Act on April 8, 2015.

Signed Alan E. McKean L.S. Number R.C.E. 19965
Alan E. McKean Exp. 9/30/15



COUNTY SURVEYOR'S STATEMENT

This Corner Record was received 5-18-2015 and examined
and filed 7-28-2015.

Signed [Signature] Title County Surveyor

County Surveyor's Comment SEE PRE-CONSTRUCTION CR 6513

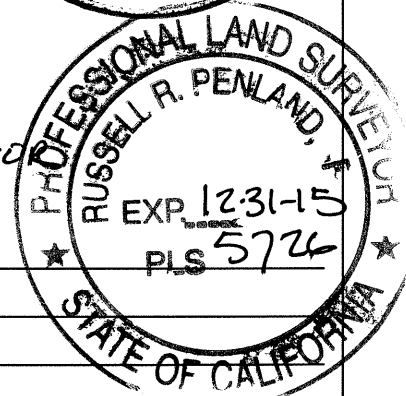

SPEC. 2254
Post

 SCALE: 1"=30'

LEGEND

● SET BRASS DISC IN MONUMENT WELL STAMPED RCE 19965

⊗ SET CUT CROSS IN WALK

AA##A# ALAMEDA COUNTY MONUMENT ID

5094 STREET ADDRESS

