

CORNER RECORD

Bk46 Pg 93
CR 5199

APN No. 99B - 7750 - 4 - (Optional) Document Number CR 5199
LIVERMORE County of ALAMEDA, California
 Brief Legal Description MONUMENTS ON ALTAMONT PASS ROAD AT POST-0A AND POST-0B PER R-693-1 & LL-693-17

<div style="border: 1px solid black; width: 100px; height: 100px; position: relative;"> <div style="position: absolute; top: 0; right: 0; width: 50%; height: 50%; border: 1px solid black;"></div> </div>	CORNER TYPE		COORDINATES (Optional)
	Government Corner <input type="checkbox"/>	Control <input type="checkbox"/>	N. _____
	Meander <input type="checkbox"/>	Property <input type="checkbox"/>	E. _____
	Rancho <input type="checkbox"/>	Other <input checked="" type="checkbox"/>	Zone _____ Datum _____
Date of Survey <u>SEPT.</u> , 2010		Elev. _____	

Corner - Left as found ☐ Found and tagged ☐ Established ☐ Reestablished ☐ Rebuilt ☒

In compliance with Section 8771 of the Professional Land Surveyors' Act, this corner record is being filed to
 ESTABLISH _____ / REESTABLISH ☒ the position of an existing monument PRIOR _____ / SUBSEQUENT ☒
 to street or highway reconstruction. (Use this portion only when applicable.)

Identification and type of corner found: Evidence used to identify or procedure used to establish or reestablish the corner:
THE MONUMENTS BELOW WERE EACH REFERENCED BY FOUR 'MAG' NAILS SET IN AC PAVEMENT AS 2' OFFSET SPREADERS
SEE DRAWING NEXT PAGE.

A description of the physical condition of the monument as found and as set or reset: SET ALAMEDA COUNTY MONUMENT
DISKS WITH PUNCH STAMPED "MW63R5" (POST-0A) AND "LV52Q4" (POST-0B) IN CONCRETE POST. THE DISK REPLACES
A FOUND IRON BOLT AS REFERENCED BY FOUR 'MAG' NAIL SPREADERS PRIOR TO REMOVAL.

SURVEYOR'S STATEMENT

This Corner Record was prepared by me or under my direction in conformance with
 the Land Surveyors' Act on October 18, 2012.

Signed Gregory Donald Hollfelder L.S. or R.C.E. Number 5918



COUNTY SURVEYOR'S STATEMENT

This Corner Record was received 10-18 2012 and examined
 and filed 10-25 2012.

Signed Red [Signature] Title County Surveyor



County Surveyor's Comment _____



① LL-693-17

② R-693-1

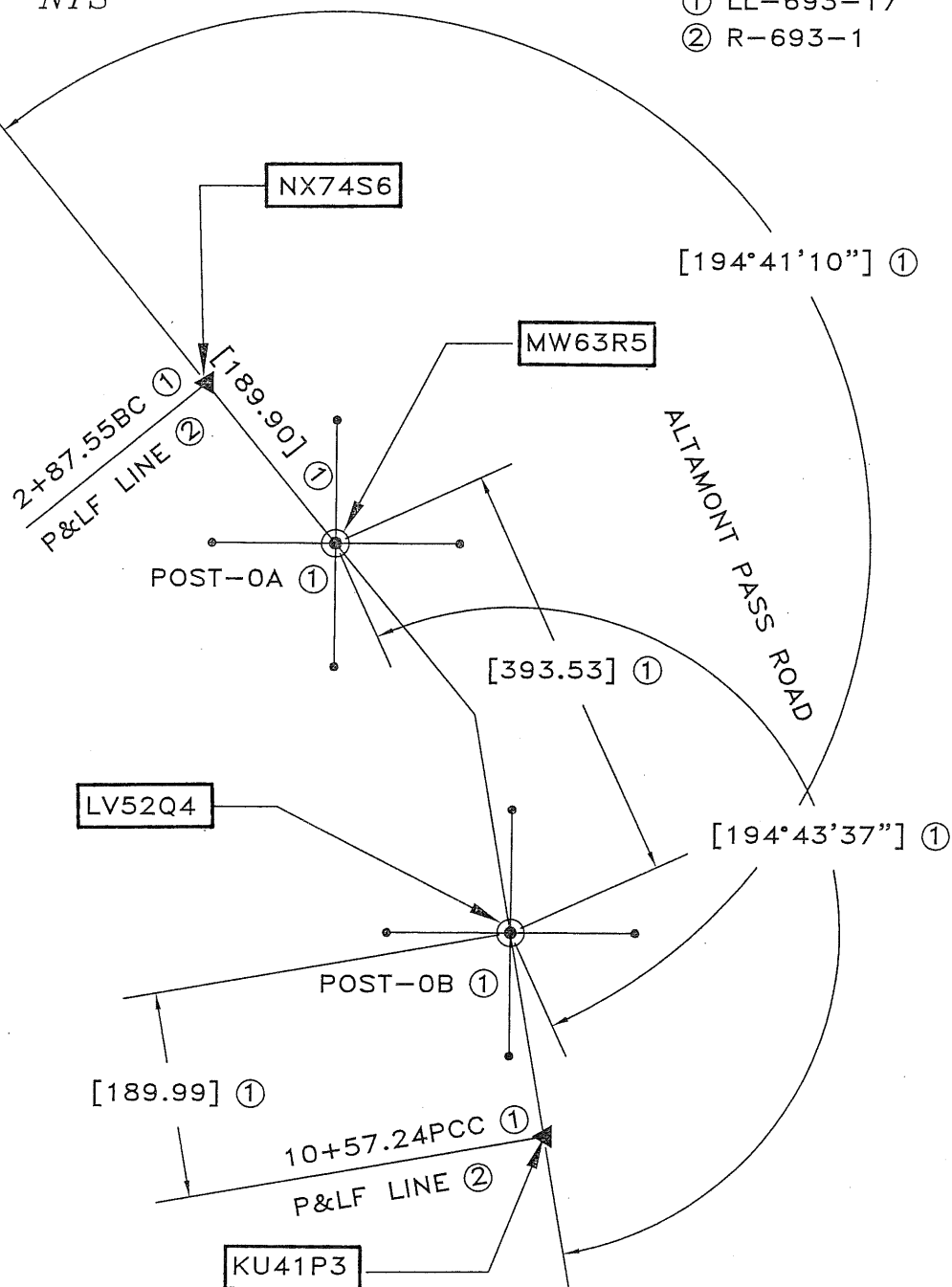

LEGEND: (●) SET WELL MONUMENT DISK WITH PUNCH IN CONCRETE
TO REPLACE IRON BOLT PER (1)

● SET 'MAG' NAIL

▲ NON-VERIFIED RECORD RAILROAD SPIKE

[] NON-VERIFIED RECORD DIMENSION